

PtAu	尺寸A	尺寸B
2x2	1.00	2.40
2x3	2.00	3.40
2x4	3.00	4.40
2x5	4.00	5.40
2x6	5.00	6.40
2x7	6.00	7.40
2x8	7.00	8.40
2x9	8.00	9.40
2x10	9.00	10.40
2x11	10.00	11.40
2x12	11.00	12.40
2x13	12.00	13.40
2x14	13.00	14.40
2x15	14.00	15.40
2x16	15.00	16.40
2x17	16.00	17.40
2x18	17.00	18.40
2x19	18.00	19.40
2x20	19.00	20.40
2x21	20.00	21.40
2x22	21.00	22.40
2x23	22.00	23.40
2x24	23.00	24.40
2x25	24.00	25.40
2x26	25.00	26.40
2x27	26.00	27.40
2x28	27.00	28.40
2x29	28.00	29.40
2x30	29.00	30.40
2x31	30.00	31.40
2x32	31.00	32.40
2x33	32.00	33.40
2x34	33.00	34.40
2x35	34.00	35.40
2x36	35.00	36.40
2x37	36.00	37.40
2x38	37.00	38.40
2x39	38.00	39.40
2x40	39.00	40.40
2x41	40.00	41.40
2x42	41.00	42.40
2x43	42.00	43.40
2x44	43.00	44.40
2x45	44.00	45.40
2x46	45.00	46.40
2x47	46.00	47.40
2x48	47.00	48.40
2x49	48.00	49.40
2x50	49.00	50.40

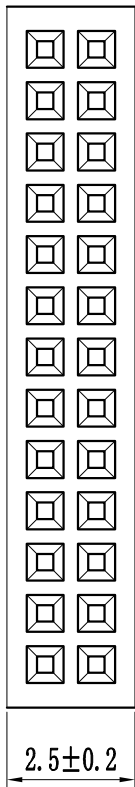

PC
1.5
1.8
2.0

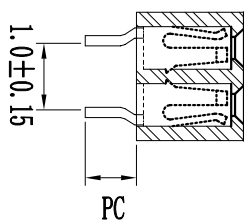
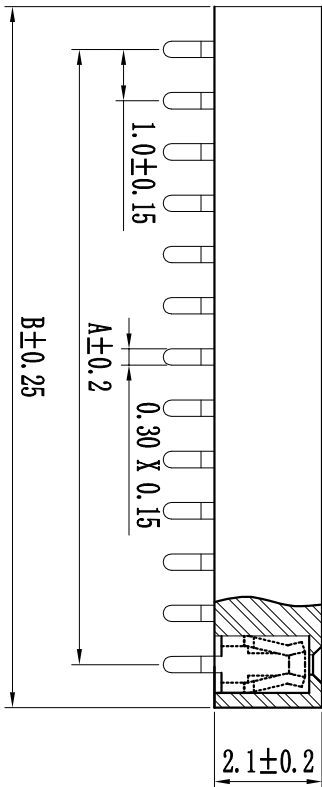

技术规范:
 额定电流 : 1AMP
 适用温度 : -40°C to +105°C
 接触电阻 : 30mΩ Max
 绝缘电阻 : 1000MΩ Min
 耐电压 : AC 500V
 绝缘材料 : Polyester (UL94V-0)
 Standard: PA-6T
 端子材质 : Bronze
 电镀规范 : Au or Sn Over 50u" Ni

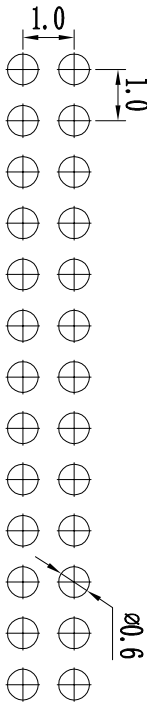

PCB LAYOUT

排针系列	间距	长度	双排	单排	Pin数	电镀	材质	角度	端子	备注
c-1.0mm	1.0mm	1-10mm	1-单排	1-单排	1" 40P/50P	B-1u"	A3-PT	S=90°	12.5mm间距25	0-3.0
b-1.0mm	1.0mm	2-双排	2-双排	2-双排	2" 40P/50P	B-5u"	B-PT45	R=90°	11.0mm间距18	1-3.0,0.6 (双排)
c-1.27mm	1.27mm	3-三排	3-三排	3-三排	3" 40P/50P	C-5u"	C-PT45	F=90°	12.5mm间距22	2-3.0,0.3 (双排)
d-2.0mm	2.0mm	4-四排	4-四排	4-四排	4" 40P/50P	D-10u"	D-PT45	L=90°	100#带绝缘端子	2-2.0,0.4 (双排)
e-2.5mm	2.5mm					E-15u"	E-PT45	H=135°	100#带绝缘端子	4-2.0,0.3 (双排)
f-3.0mm	3.0mm					F-20u"	F-PT45		100#带绝缘端子	其它另做说明
h-5.0mm	5.0mm					H-50u"	H-PT45		100#带绝缘端子	
i-6.0mm	6.0mm					I-60u"	I-PT45		100#带绝缘端子	

注: 长度均以英寸计

客户确认

姓名: _____ 日期: _____
 审核: _____ 日期: _____
 承做 _____ 日期: _____
 退回 _____ 日期: _____

THIRD ANGLE PROJECTION

上海狮拓电子科技有限公司



产品名: _____
 产品料号: _____

TOLERANCE:
 X ±XXX
 XX ±0.20
 XXX ±0.10
 ANG.